

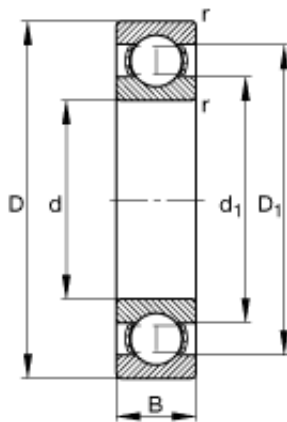

BEARING MFG. CORP.



35 mm x 72 mm x 17 mm GEG100ES Spherical Plain Bearing 100x160x85mm

Bearing No. 6207

6207 Bearing 2D drawings and 3D CAD models

Size	35x72x17 mm
Bore Diameter	35 mm
Outer Diameter	72 mm
Width	17 mm
d	35 mm
D	72 mm
B	17 mm
D_1	60,7 mm
$D_{a \max}$	65 mm
d_1	47,2 mm
$d_{a \min}$	42 mm
$r_{a \max}$	1 mm
r_{\min}	1,1 mm
m	0,291 kg / Weight
C_r	27500 N / Dynamic load rating (radial)
C_{0r}	15300 N / Static load rating (radial)
n_G	13800 1/min / Limiting speed
n_B	10300 1/min / Reference speed
C_{ur}	770 N / Fatigue limit load, radial